



# Manual Galley Pump - Foot Operated

## Tiptoe Pump Mk 4

**Tiptoe Pump Mk 4 GP1309 - Self-Priming Fresh Water Pump. Introduced 1999.**

**Note\*** Contained in Service Kit AK1304

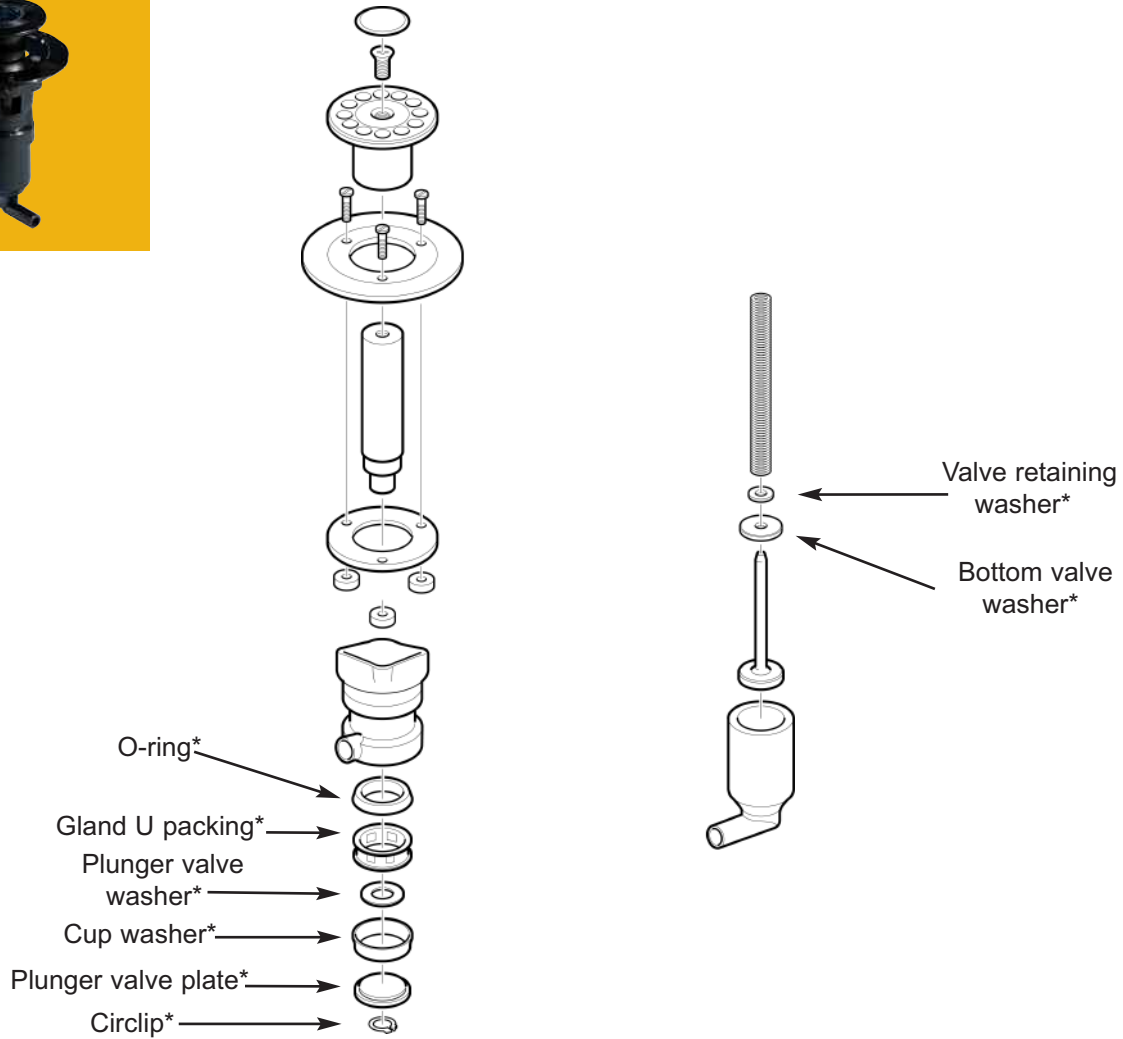

### Accessories

**WF1530 Silverised Carbon Water Filter (inline)**

### Service Kits

**AK1304 Service Kit with Complete Set of Serviceable Parts for Tiptoe Mk 3 or Mk 4**

Qty	Containing
1	Cup washer
1	Gland U packing
1	Bottom valve washer
1	Plunger valve washer
1	Plunger valve plate
1	Circlip
1	Valve retaining washer
1	O-ring



AK1304



WF1530

# Customer Support Services

Whale employees are committed to providing excellent customer service and product installation and maintenance advice.

**Contact our customer service team  
for technical advice:**



## Whale Support

UK

tel: +44 (0)28 9127 0531  
fax: +44 (0)28 9146 6421  
info@whalepumps.com  
whalepumps.com

USA

tel: +1 802 367 1091  
fax: +1 802 367 1095  
usasales@whalepumps.com  
whalepumps.com

Call us directly for product and installation advice

*“It is refreshing to find a manufacturer that not only supplies first rate products but also gives excellent back up service...”*

Ken Bell, letter to Inland Waterways News

### Boat Builder Technical Partnership

Our technical support team of highly skilled marine engineers work in partnership with power and sailboat builders around the world. This collaboration delivers bespoke systems that are ideal for each builder, saving both time and money.

**Please note:** Illustrations are for guidance only.  
For installation advice please contact Whale directly.

Neither the accuracy nor completeness of the information contained in this brochure is guaranteed by Munster Simms Engineering Limited and Whale Water Systems Inc. (a wholly owned subsidiary of Munster Simms Engineering Limited) and may be subject to change at its sole discretion. Munster Simms Engineering Limited and Whale Water Systems Inc. (a wholly owned subsidiary of Munster Simms Engineering Limited) may, at its sole discretion, change the technical performance, dimensions or appearance of any of its Whale products without prior notification to a purchaser.

Copyright Whale 2012- All rights reserved. WHALE®, GUSHER®, GULPER®, SMARTBAIL®, WHALE IC®, WHALE IC DEVICE and BABYFOOT® are trademarks of Munster Simms Engineering Limited, Bangor, Northern Ireland trading as Whale.

Whale's policy is one of continuous improvement and we reserve the right to change specifications without prior notice. Illustrations are for guidance purposes only.

Please note that by contacting Whale Support you will be indicating your consent to receiving product updates, recall information, help guides and appropriate marketing messages from us via post, email or telephone unless you indicated an objection to receiving such messages.

Santoprene® is a registered trade name of Advanced Elastomer Systems, LP, an Exxonmobil Chemical Affiliate.

Delrin®, Teflon® and Neoprene are registered trade names of Dupont Neumeurs and Co.

Monprene® is a registered trade name of Technore Apex.

Ref:db\_pshaw\_180.36\_v3\_0912