

ITALIANO

INSTALLAZIONE / USO / MANUTENZIONE - IT

ENGLISH

INSTALLATION / USE / MAINTENANCE - GB

FRANÇAIS

INSTALLATION / USAGE / ENTRETIEN - FR

DEUTSCH

INSTALLATION / GEBRAUCH / WARTUNG - DE

ESPAÑOL

INSTALACIÓN / USO / MANUTENCIÓN - ES

PORTUGUÊS

INSTALAÇÃO / UTILIZAÇÃO / MANUTENÇÃO - PT

NEDERLANDS

INSTALLATIE / GEBRUIK / ONDERHOUD - NL

DANSK

INSTALLATION / BRUG / VEDLIGEHOLDELSE - DK

SUOMI

ASENNUS / KÄYTTÖ / HUOLTO - FI

SVENSKA

INSTALLATION / ANVÄNDNING / UNDERHÅLL - SE

NORSK

INSTALLASJON / BRUK / VEDLIKEHOLD - NO

SLOVENSKI

INSTALACIJA / UPORABA / VZDRŽEVANJE - SI

7003 - 7023 - 7103 - 7123 - 8103VD - 8103VDM - 8123VD - 8123VDM
8203 - 8203 M - 8223 - 8223 M - MO8302 - MO8303 - MO8322 - MO8323
MO8342 - MO8362 - MO8801D - MO8801S - MO8821D - MO8821S
MO9122 - MO9202D - MO9202S - MO9222D - MO9222S - PI7203 - PI7223 - PI7703
PI7723 - PI8002 - PI8003 - PI8022 - PI8023 - PI8042 - PI8043 - PI8062 - PI8063
PI8403 - PI8423 - PI8443 - PI8463 - PI8502 - PI8503 - PI8522 - PI8523 - PI8542
PI8543 - PI8562 - PI8563 - PI8621A - PI8621R - PI8621S - PI8802D - PI8802S
PI8822D - PI8822S - PI8842D - PI8842S - PI8862D - PI8862S - PI9003 - PI9023



SYMBOLS

WARNINGS AND SAFETY SYMBOLS

The safety symbols utilised identify possible hazards to users.
Always respect all safety warnings identified with these symbols:



WARNING
Hazard of injury or death.



CAUTION
To prevent possible injury
and / or damage

INDEX

INSTALLATION	13
SAFETY WARNINGS	13
CABINET APERTURE	13
CONNECTING TO GAS SUPPLY	14
WIRING- CONNECTING TO ELECTRICITY SUPPLY	15
FIXTURE	15
USE	16
WARNINGS	16
CONTROLS	16
BURNERS:	17
HOB:	18
SELECTING BURNER	18
ELECTRONIC IGNITION HOB (DEPENDING ON MODEL)	18
MANUAL IGNITION HOB	18
HOB FLAME REGULATION	18
VISUAL FLAME CONTROL	19
GAS CYLINDERS / BOTTLES	19
MAINTENANCE	20
CLEANING	20
INJECTORS	20
SMEV ACCESSORIES	20
TEST PRESSURE POINT10	20
FIGURES AND TECHNICAL DRAWINGS	122-135

SAFETY WARNINGS



WARNING

THIS APPLIANCE MUST BE INSTALLED IN ACCORDANCE WITH THE REGULATIONS IN FORCE AND ONLY USED IN AN ADEQUATELY VENTILATED AREA. ALWAYS READ THE INSTRUCTIONS PROVIDED THOROUGHLY BEFORE INSTALLING AND USING THIS APPLIANCE. THIS APPLIANCE MUST BE INSTALLED BY SPECIALISED GAS SERVICE ENGINEERS.

THIS APPLIANCE IS DESIGNED AND MANUFACTURED FOR COOKING FOOD ONLY. ANY OTHER USE IS CONSIDERED IMPROPER AND INCORRECT CREATING HAZARDOUS CONDITIONS. THE MANUFACTURER DECLINES ALL RESPONSIBILITY FOR DAMAGE TO THINGS OR INJURIES TO PERSONS CAUSED BY INCORRECT INSTALLATION AND / OR INCORRECT AND IMPROPER USE.



CAUTION

BEFORE INSTALLING CHECK THAT THE LOCAL GAS AVAILABLE (GAS TYPE AND PRESSURE) AND THE APPLIANCE REGULATORS ARE COMPATIBLE WITH THE APPLIANCE ITSELF.

GAS REGULATING SPECIFICATIONS FOR THIS APPLIANCE ARE PROVIDED ON THE LABEL AFFIXED TO THE APPLIANCE (OR ON THE SERIAL PLATE).

THIS APPLIANCE IS NOT CONNECTED TO A FUME EXTRACTION FLUE FOR EXTRACTING PRODUCTS OF COMBUSTION THEREFORE IT MUST BE INSTALLED AND CONNECTED (FITTED) CONFORMING TO INSTALLATION REGULATIONS IN FORCE FOR APPLIANCES OF THIS TYPE. IT IS OF UTMOST IMPORTANCE TO RESPECT LEGISLATION REGARDING VENTILATION.

CABINET APERTURE



WARNING

THE APPLIANCE MUST FITTED AT AN APPROPRIATE AND SAFE DISTANCE FROM FLAMMABLE MATERIALS.

This hob has a class 3 grading: BUILT-IN APPLIANCE FOR KITCHENS OR WORKTOPS

MINIMUM ALLOWABLE DISTANCES FROM WALLS (FIG. 1 - PG. 122):

A / B	FROM THE OUTER EDGE OF THE BURNER HEAD NEAREST ONE OF THE SIDE WALLS AND / OR REAR WALL: 135 mm
C	THE DISTANCE BETWEEN THE TOP OF THE BURNER AND THE BOTTOM OF THE UNITS AND / OR SHELVES FITTED ABOVE THE HOB: 500 mm
D	THE DISTANCE BETWEEN THE BOTTOM OF THE BURNER AND THE UNDERSIDE: 30 mm

SIZE OF CABINET APERTURE

Cut-out a hole in the cabinet as illustrated in FIG. 2 - PG. 123 depending on model to install.

The cabinet must be appropriately constructed and aligned horizontally with the worktop and with the unit. The cabinet aperture must be perfectly squared and aligned.

If there are apertures for cabinet ventilation, prevent flammable materials from entering these.

Models PI862IA, PI862IS and PI862IR are modular.

It is possible to connect from 1 to 5 appliances in series.

ALWAYS RESPECT THE DISTANCE BETWEEN ONE CABINET APERTURE AND ANOTHER (FIG. 2 – PG. 130).

CONNECTING TO GAS SUPPLY



WARNING

CHECK THESE SPECIFICATIONS BEFORE CONNECTING THE APPLIANCE TO THE GAS CYLINDER /BOTTLE. THE PRESSURE REGULATORS CONNECTED BETWEEN THE GAS CYLINDER AND APPLIANCE MUST CONFORM WITH THE CATEGORIES GIVEN IN THE TABLE BELOW.

This appliance is designed for running off the following types of gas at the corresponding operating pressures. The gas category (or categories) of the appliance is given on the specifications label affixed to the appliance.

CATEGORY AND COUNTRY OF DESTINATION	GAS PRESSURE
I3B/P(30) AT BE DK FI DE GB NL NO SE CH SI	30 mbar Butane (G30) 30 mbar Propane (G31)
I3+ (28-30/37) BE FR IE IT ES CH GB PT SI	28-30 mbar Butane (G30) 37 mbar Propane (G31)

MODEL	TOTAL NOMINAL THERMAL CAPACITY kW - gr/h	AIR VOLUME REQUIRED FOR COMBUSTION m ³ /h
MO8801D - MO8801S - MO8821D MO8821S - PI8621A	1,0 - 73	2,0
PI8621S	1,8 - 131	3,6
PI8621R	2,2 - 160	4,4
MO8302 - MO8322 - MO8342 MO8362 - MO9202D - MO9202S MO9222D - MO9222S PI8002 - PI8022 - PI8042 - PI8062 PI8502 - PI8522 - PI8542 - PI8562	2,8 - 204	5,6
PI8802D - PI8802S - PI8822D - PI8822S PI8842D - PI8842S - PI8862D - PI8862S	3,2 - 233	6,4
MO9122	3,6 - 262	7,2
7003 - 7023 - 7103 - 7123 8103 VD - 8103 VDM 8123 VD - 8123 VDM 8203 - 8203 M - 8223 - 8223 M MO8303 - MO8323 - PI9003 - PI9023	3,8 - 277	7,6
PI7203 - PI7223 - PI7703 - PI7723 PI8003 - PI8023 - PI8043 - PI8063 PI8403 - PI8423 - PI8443 - PI8463 PI8503 - PI8523 - PI8543 - PI8563	4,6 - 335	9,2



WHEN INSTALLING AND CONNECTING THE APPLIANCE TO THE GAS SUPPLY, ENSURE THAT THE GAS SUPPLY HOSE IS NOT TWISTED, STRETCHED OR SUBJECTED TO ANY FORM OF STRAIN WHICH COULD CREATE A HAZARD.

WARNING

The gas supply pipe connected to the appliance must be a rigid metal pipe with sealed fittings. It is possible to fit a flexible hose, however, in this case the following conditions must be respected:

- a) The hose can be accessed easily for inspection;
 - b) The hose must be protected against coming into contact with parts which heat up (for example parts underneath the burners);
 - c) The hose must be protected against being damaged (twisting, pulling, trapping,...);
 - d) The hose must be protected against being trapped by moving parts (e.g. drawers);
 - e) The hose must not have a length over 1.5 m;
 - f) The hose must be replaced before its expiry date;
- For models PI8621A, PI8621S, PI8621R seal the appliance gas pipe utilising the sealed tube with pre-mounted gas fitting provided. Once the appliance has been connected to the gas supply check for gas leaks utilising a non-corrosive fluid. Do not use a water and soap solution. **NEVER USE A FLAME TO TEST FOR GAS LEAKS**

Models PI8621A, PI8621S and PI8621R are modular. It is possible to connect from 1 to 5 appliances in series. Disconnect and remove the sealed tube mounted to the gas pipe on the installed appliance and connect it to the gas pipe on the appliance to install. Connect the appliances together by connecting the gas pipes in series utilising the fitting.

CONNECTING TO ELECTRICITY SUPPLY

This chapter refers only to models with the wording 12VDC on the appliance specifications label affixed to the appliance.



THIS APPLIANCE MUST BE CONNECTED TO A 12VDC POWER PACK ONLY. THE CIRCUIT MUST BE FITTED WITH A SAFETY FUSE NOT HIGHER THAN 3 AMP.

WHEN WIRING RESPECT CORRECT POLARITY!



IT IS OF UTMOST IMPORTANCE NEVER TO CONNECT THIS APPLIANCE TO MAINS VOLTAGE (230V) WHICH IRREVERSIBLY DAMAGES APPLIANCE COMPONENTS AND CREATES A HAZARD TO THE USER.

WARNING

To connect the appliance use a 1.5 mm² double red and black wire and wire to the terminal junction box located at the rear of the appliance. The red terminal is the positive pole and the black terminal is the negative pole.

FIXTURE

THIS APPLIANCE MUST BE FITTED AND SECURED TO THE CABINET UTILISING THE FIXTURE SCREWS AS ILLUSTRATED IN FIG. 3 - PG.131.

WARNINGS



CAUTION

THIS APPLIANCE MUST ONLY BE USED BY RESPONSIBLE ADULTS. DURING USE AND IMMEDIATELY AFTER USE THE BURNER AND OTHER ACCESSIBLE PARTS MAY BE HOT; DO NOT TOUCH THESE PARTS AND ALWAYS KEEP CHILDREN AT A SAFE DISTANCE. AFTER USING THE APPLIANCE ENSURE THE KNOB/KNOBS ARE OFF. AFTER USE ALWAYS SHUT OFF THE GAS SUPPLY AT THE MAIN GAS TAP.



WARNING

THE USE OF GAS APPLIANCES GENERATES HEAT AND MOISTURE IN THE IMMEDIATE AREA. ALWAYS ENSURE A GOOD VENTILATION IN THE COOKING AREA. KEEP ALL AIR VENTS OPEN FOR NATURAL VENTILATION OR INSTALL AN EXTRACTOR FAN (COOKERHOOD).

DUE TO INTENSIVE USE OF THE APPLIANCE IT MAY BE NECESSARY TO INCREASE VENTILATION SUCH AS OPENING A WINDOW OR INCREASING COOKERHOOD (EXTRACTOR FAN) SPEED.

FOR MODELS MO8800 THE DRAINER MUST BE REMOVED WHEN UTILISING THE HOB BURNER/S.



CAUTION: THIS WARNING IS AFFIXED IN VISIBLE LOCATION ON THE HOB GLASS LID. GLASS HOB LIDS MAY SHATTER WHEN HEATED. ALWAYS RAISE THE LID BEFORE IGNITING A BURNER/S (HOB, OVEN AND GRILL) AND TURN OFF ALL BURNERS (HOB, OVEN AND GRILL) AND LET THEM COOL DOWN BEFORE LOWERING THE HOB GLASS LID.



CAUTION: THIS WARNING REFERS TO MODELS WITH INCORPORATED SINK UNIT AND HOB AND WITH GLASS LID DIVIDED BETWEEN SINK AND HOB. THIS WARNING IS AFFIXED IN A VISIBLE POSITION ON THE SINK UNIT GLASS LID. WHEN USING THE HOB WITH THE GLASS LID ON THE SINK UNIT CLOSED, ALWAYS KEEP PANS ON HOB AT A DISTANCE OF 10 MM MINIMUM FROM SINK UNIT GLASS LID.

CONTROLS

The following symbols indicate the burner corresponding to the control knob.

NOTE: different models may have different knobs and different symbols.



THIS SYMBOL IS PLACED NEXT TO THE HOB BURNER KNOBS. FULL DOT REFERS TO THE CORRESPONDING HOB BURNER.

The following symbols indicate the burner regulation corresponding to the knob position.

NOTE: different models may have different knobs and different symbols.



GAS OFF



HIGH FLAME



LOW FLAME

OTHER SYMBOLS



PUSHBUTTON ELECTRONIC IGNITION

BURNERS

Technical specifications for burners referring to appliance model:

MODEL	THERMAL CAPACITY BURNERS								
	AUXILIARY Ø 47 mm			SEMI-RAPID Ø 62 mm			RAPID Ø 77 mm		
	nr.	Kw	gr/h	nr.	Kw	gr/h	nr.	Kw	gr/h
7003	2	1	73	1	1,8	131			
7023	2	1	73	1	1,8	131			
7103	2	1	73	1	1,8	131			
7123	2	1	73	1	1,8	131			
8103VD	2	1	73	1	1,8	131			
8103VDM	2	1	73	1	1,8	131			
8123VD	2	1	73	1	1,8	131			
8123VDM	2	1	73	1	1,8	131			
8203	2	1	73	1	1,8	131			
8203 M	2	1	73	1	1,8	131			
8223	2	1	73	1	1,8	131			
8223 M	2	1	73	1	1,8	131			
MO8302	1	1	73	1	1,8	131			
MO8303	2	1	73	1	1,8	131			
MO8322	1	1	73	1	1,8	131			
MO8323	2	1	73	1	1,8	131			
MO8342	1	1	73	1	1,8	131			
MO8362	1	1	73	1	1,8	131			
MO8801D	1	1	73						
MO8801S	1	1	73						
MO8821D	1	1	73						
MO8821S	1	1	73						
MO9122				2	1,8	131			
MO9202D	1	1	73	1	1,8	131			
MO9202S	1	1	73	1	1,8	131			
MO9222D	1	1	73	1	1,8	131			
MO9222S	1	1	73	1	1,8	131			
PI7203	1	1	73	2	1,8	131			
PI7223	1	1	73	2	1,8	131			
PI7703	1	1	73	2	1,8	131			
PI7723	1	1	73	2	1,8	131			
PI8002	1	1	73	1	1,8	131			
PI8003	1	1	73	2	1,8	131			
PI8022	1	1	73	1	1,8	131			
PI8023	1	1	73	2	1,8	131			
PI8042	1	1	73	1	1,8	131			
PI8043	1	1	73	2	1,8	131			
PI8062	1	1	73	1	1,8	131			
PI8063	1	1	73	2	1,8	131			
PI8403	1	1	73	2	1,8	131			
PI8423	1	1	73	2	1,8	131			
PI8443	1	1	73	2	1,8	131			
PI8463	1	1	73	2	1,8	131			
PI8502	1	1	73	1	1,8	131			
PI8503	1	1	73	2	1,8	131			
PI8522	1	1	73	1	1,8	131			
PI8523	1	1	73	2	1,8	131			
PI8542	1	1	73	1	1,8	131			
PI8543	1	1	73	2	1,8	131			
PI8562	1	1	73	1	1,8	131			
PI8563	1	1	73	2	1,8	131			
PI8621A	1	1	73						
PI8621R							1	2,2	160
PI8621S				1	1,8	131			
PI8802D	1	1	73				1	2,2	160
PI8802S	1	1	73				1	2,2	160
PI8822D	1	1	73				1	2,2	160
PI8822S	1	1	73				1	2,2	160
PI8842D	1	1	73				1	2,2	160
PI8842S	1	1	73				1	2,2	160
PI8862D	1	1	73				1	2,2	160
PI8862S	1	1	73				1	2,2	160
PI9003	2	1	73	1	1,8	131			
PI9023	2	1	73	1	1,8	131			

HOB**- SELECTING BURNER**

WARNING

THE FLAME MUST NEVER EXTEND BEYOND THE EDGE OF THE PAN. CENTRE THE PAN OVER THE BURNER ENSURING STABILITY ON THE PAN SUPPORT.

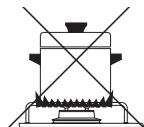

BURNER	PAN DIAMETER
AUXILIARY Ø 47 mm	from 6 to 16 cm
SEMI-RAPID Ø 62 mm	from 16 to 22 cm
RAPID Ø 77 mm	from 16 to 22 cm

- ELECTRONIC IGNITION HOB (DEPENDING ON MODEL)

WARNING

MAKE SURE THERE ARE NO PANS OR OTHER ANY OBJECTS ON THE BURNERS WHEN IGNITING.

To ignite burner, gently push-in and turn the control knob to position HIGH FLAME and maintaining the knob pushed at the same time press the electronic ignition pushbutton. Once the burner is alight maintain the knob in this position for a few seconds to the ensure the flame remains alight.



CAUTION

IF THE BRUNER DOES NOT IGNITE IMMEDIATELY REPEAT IGNITION AFTER HAVING FOLLOWED EACH STEP BELOW:

- TURN THE KNOB TO "SMALL FLAME"
- PROCEED WITH MANUAL IGNITION
- CHECK THERE IS SUFFICIENT GAS IN THE GAS BOTTLE.

IF THE APPLIANCE STILL DOES NOT IGNITE SHUT OFF THE GAS SUPPLY AT THE MAIN GAS TAP AND CONTACT YOUR LOCAL DEALER.

-MANUAL IGNITION HOB

Manual ignition when the appliance is not fitted with the electronic ignition feature or in the event of failure in the electronic ignition.



WARNING

MAKE SURE THERE ARE NO PANS OR OTHER ANY OBJECTS ON THE BURNERS WHEN IGNITING.

To ignite burner, gently push-in and turn the control knob to position HIGH FLAME and maintaining the knob pushed at the same time light the burner with a match or gas lighter. Once the burner is alight maintain the knob in this position for a few seconds to ensure the flame remains alight.



CAUTION

IF THE BURNER DOES NOT IGNITE IMMEDIATELY CHECK THERE IS SUFFICIENT GAS IN THE GAS BOTTLE.

IF THE APPLIANCE STILL DOES NOT IGNITE SHUT OFF THE GAS SUPPLY AT THE MAIN GAS TAP AND CONTACT YOUR LOCAL DEALER.

- HOB FLAME REGULATION

To regulate flame turn the knob to the desired cooking flame.

VISUAL FLAME CONTROL

Depending on the type of gas used the flame should be:

Propane (G31): blue flame without yellow tips.

Butane (G30): flame with yellow tips when ignited which becomes more intense in colour as the burner heats.

GAS CYLINDERS/BOTTLES



NEVER OPERATE THE APPLIANCE WITH GAS AND OR AT GAS PRESSURES DIFFERENT TO THOSE INDICATED BY SMEV AS THIS COULD CAUSE IRREGULAR AND INCORRECT OPERATION. SMEV DECLINES ALL RESPONSIBILITY FOR DAMAGE OR INJURY CAUSED BY AN INCORRECT OR IMPROPER USE OF THE APPLIANCE.

The appliance runs off standard gas bottles which can be found in the country of use. The type of gas to use is clearly marked on the packaging and on the specifications label affixed to the rear of the appliance. However always respect the following instructions: gas bottles must always be located and positioned in the compartment provided for this purpose. They must always be vertical and fitted with a valve and pressure regulator. Do not obstruct or impede access to the gas bottle to permit quick and easy access when replacing.

WARNING! When replacing the gas bottle always take the following precautions:

- close all gas knobs (**Pos. OFF**);
- make sure there are no flames or fires in proximity of the gas bottle;
- close the gas valve on the bottle to be replaced;
- unscrew the pressure regulator on the empty bottle and remove the bottle from the purpose compartment. This procedure is inverted for fitting a new bottle. Check for gas leaks utilising a non-corrosive fluid. Do not use a water and soap solution.

NEVER USE A FLAME TO CHECK FOR GAS LEAKS;

- ignite the burners to check they function correctly. If there are problems call in an authorised gas service engineer.

AFTER APPLIANCE USE ALWAYS TURN OFF THE GAS TAP ON THE BOTTLE

GAS LEAKS

We recommend the use of an electronic and homologated gas detector for checking ambient air.

If there is a smell of gas;

- immediately open the windows and evacuate the vehicle or caravan.
- do not turn on or off light switches or other electronic appliances, do not light matches or lighters or anything that could cause the gas to ignite;
- put out any flames
- shut off the valve on the gas bottle or cylinder. Do not re-open this valve unless the gas leak has been identified and eliminated.
- contact a specialised gas service engineer.

CLEANING



WARNING

BEFORE CLEANING THE APPLIANCE ALWAYS TURN IT OFF AND DISCONNECT FROM POWER SUPPLY AND WAIT UNTIL IT HAS COOLED DOWN.



CAUTION

SURFACES THAT ARE STILL HOT CAN BE DAMAGED IF THEY COME INTO CONTACT WITH COLD WATER OR A DAMP CLOTH. NEVER USE ABRASIVE, CORROSIVE OR CHLORINE BASED CLEANING PRODUCTS. NEVER USE STEEL OR PLASTIC SCOURING PADS. NEVER LEAVE DEPOSITS OF ACID OR ALKALINE SUBSTANCES (VINEGAR, SALT, LEMON JUICE ETC.) ON THE APPLIANCE. STAINLESS STEEL OR ENAMELLED SURFACES MUST BE CLEANED ONLY WITH WATER AND SOAP OR A NEUTRAL DETERGENT, THOROUGHLY RINSE AND DRY. USE CLEAN SPONGES OR CLOTHS TO CLEAN.

INJECTORS



WARNING

CLEANING OR REPLACING GAS INJECTORS MUST ONLY BE PERFORMED BY AUTHORISED AND QUALIFIED GAS SERVICE ENGINEERS. THE MANUFACTURER DECLINES ALL RESPONSIBILITY IN REGARD.

When removing and mounting the injectors the injector holder must be held in place with the aid of a tool (FIG. 5 - PG. 134).

BURNER	Ø INJECTOR (mm)	STAMPED N.
AUXILIARY Ø 47 mm	0,50	50
SEMI-RAPID Ø 62 mm	0,67	67
RAPID Ø 77 mm	0,75	75

SMEV ACCESSORIES

GLASS LID (FIG. 6 - PG. 135) only for models PI8621A, PI8621S, PI8621R.

This optional accessory has two functions: when closed it can be used as an additional work surface and when open, during cooking, it protects the wall behind the appliance from food splashes.

To request a **GLASS LID**, please contact your local dealer

TEST PRESSURE POINT (IF FITTED)

THE TEST PRESSURE POINT (PRESSURE CHECK VALVE) IS FITTED UNDER THE HOB. (FIG. 4 - PG. 133).

Removing and mounting this test pressure point (pressure check valve) must be performed by a qualified gas service engineer. Gas pressure is related to the type of gas used to supply the appliance. Refer to chapter GAS in this manual.

OPOMBE



FIG.

	mm
A	135
B	135
C	500
D	30

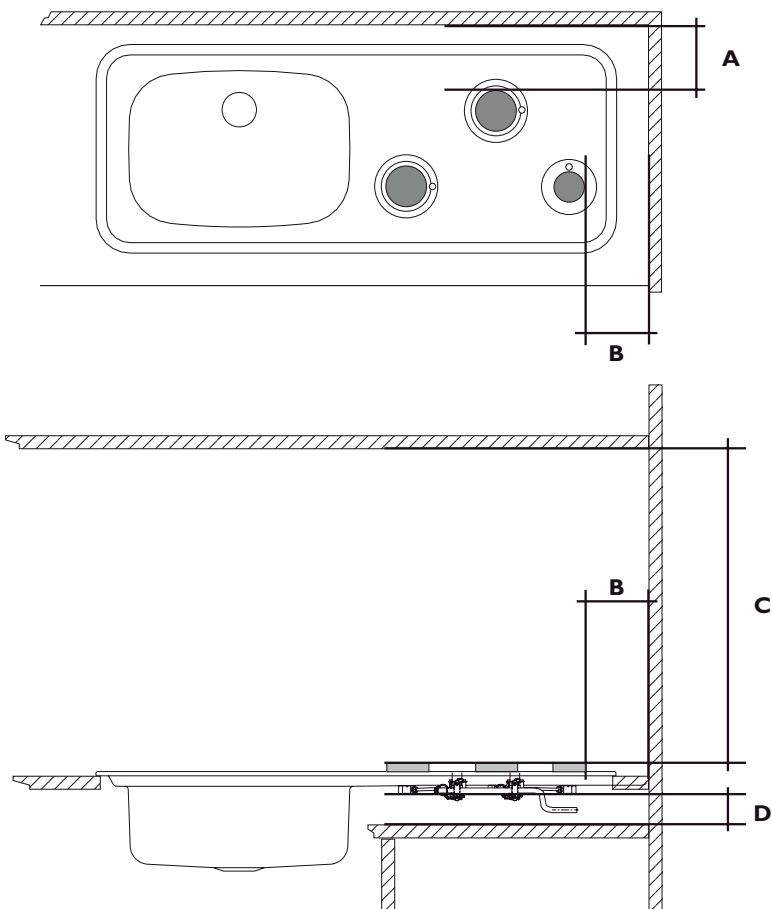

2 FIG.

MOD.	X mm	Y mm
7103	786	445,89
7123		

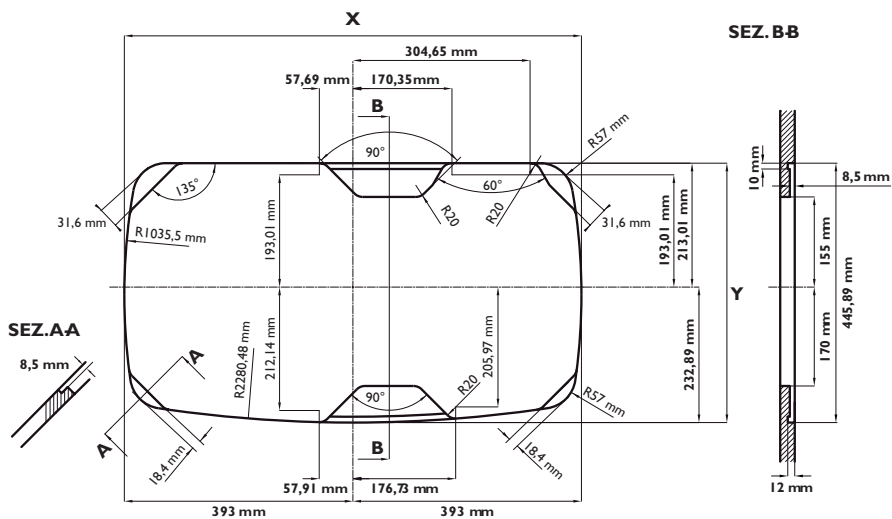

MOD.	X mm	Y mm
8103 VD	956	416
8103 VDM		
8123 VD		
8123 VDM		

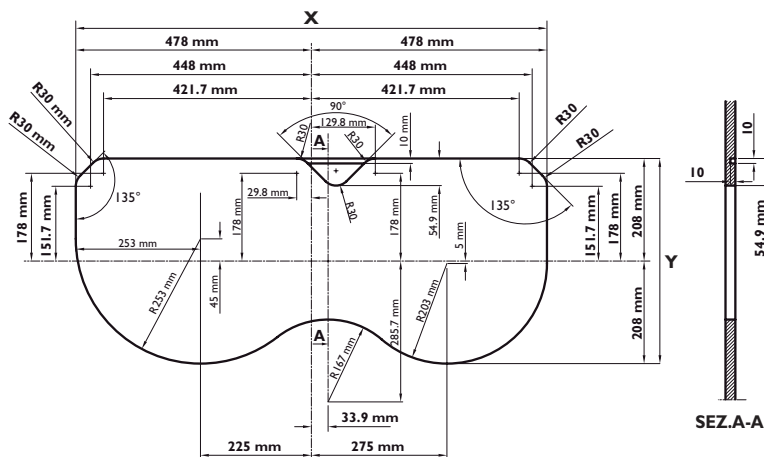

MOD.	X mm	Y mm
MO8302	666	426
MO8322		
MO8303		
MO8323		
MO8342		
MO8362		

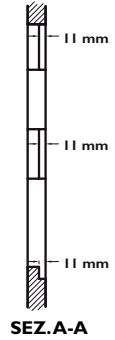
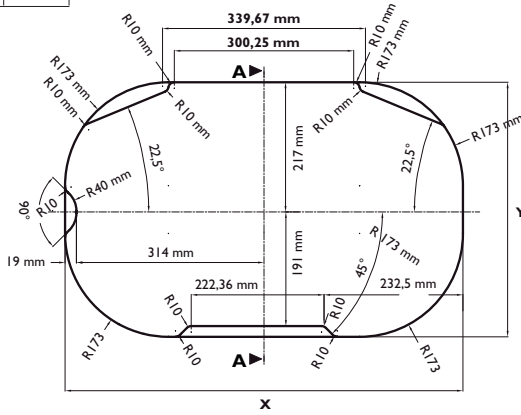

SEZ. A-A

MOD.	X mm	Y mm
PI8802D	511,02	408
PI8822D		
PI8842D		
PI8862D		
MO8801D		
MO8821D		

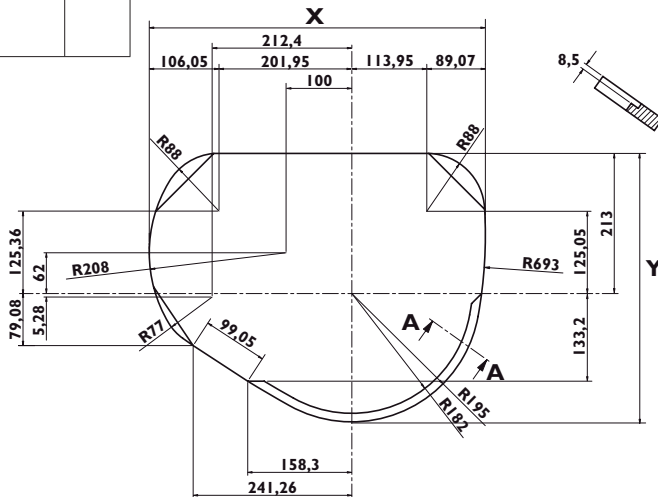

SEZ. A-A

SEZ. A-A

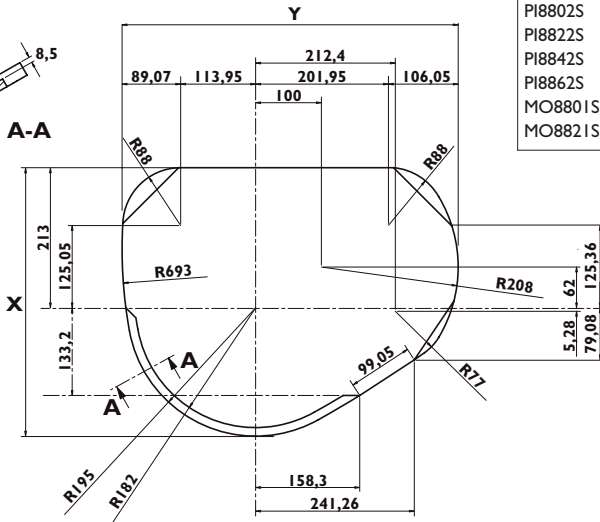

MOD.	X mm	Y mm
PI8802S	511,02	408
PI8822S		
PI8842S		
PI8862S		
MO8801S		
MO8821S		

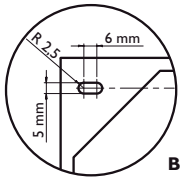

MOD.	X mm	Y1 mm	Y2 mm
MO9122	816	316,6	322,7

SEZ. A-A

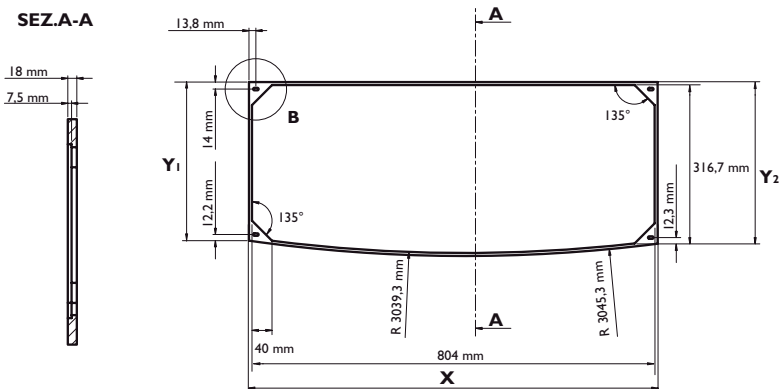

MOD.	X mm	Y mm
MO9202D	883	307
MO9222D		

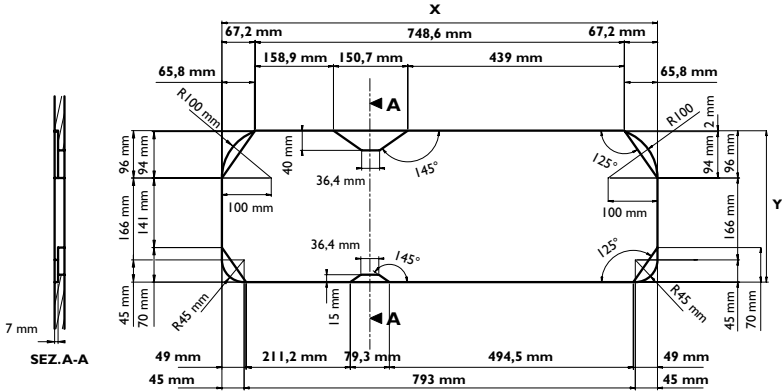

MOD.	X mm	Y mm
MO9202S	883	307
MO9222S		

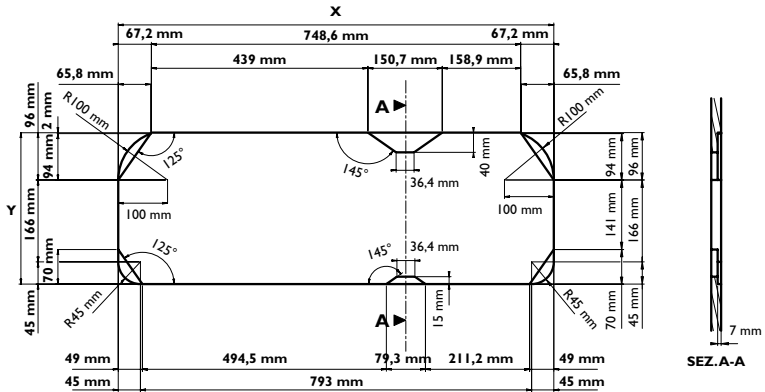

MOD.	X mm	Y mm
7003	456,2	466,1
7023		

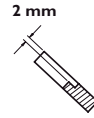
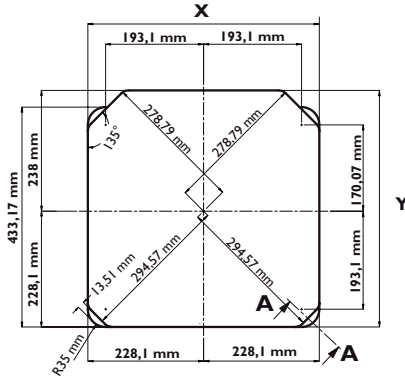

SEZ. A-A

SEZ. A-A

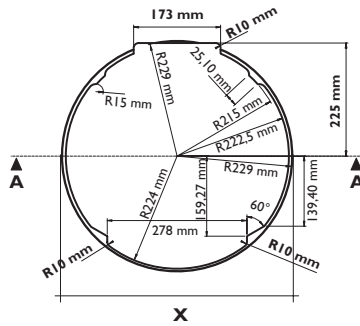

MOD.	X mm
PI7203	458
PI7223	
PI7703	
PI7723	

MOD.	X mm	Y mm
PI8002	466	358
PI8022		
PI8042		
PI8062		
PI8502		
PI8522		
PI8542		
PI8562		

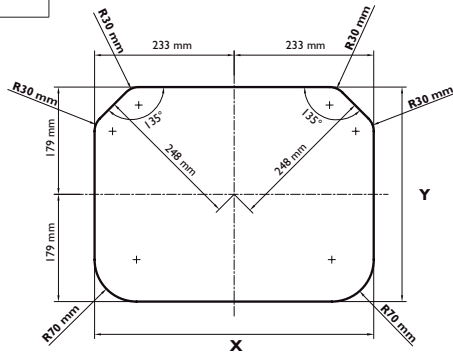

MOD.	X mm	Y mm
PI8003	546	428
PI8023		
PI8043		
PI8063		
PI8503		
PI8523		
PI8543		
PI8563		

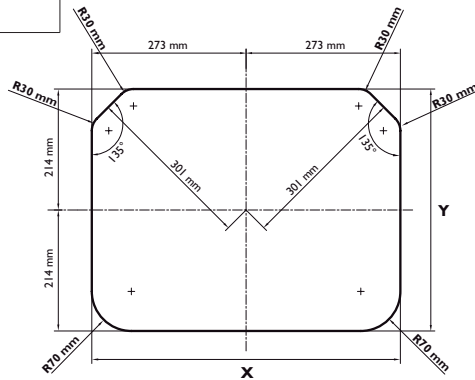

MOD.	X mm	Y mm
8203		
8203 M	506	416
8223		
8223 M		

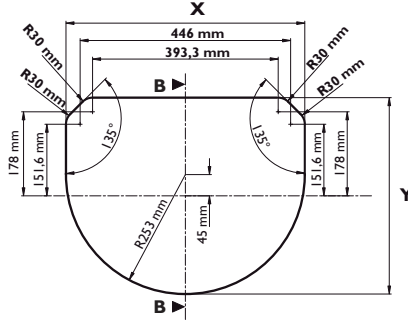

SEZ. B-B

MOD.	X mm	Y mm
PI8403		
PI8423	572	332
PI8443		
PI8463		

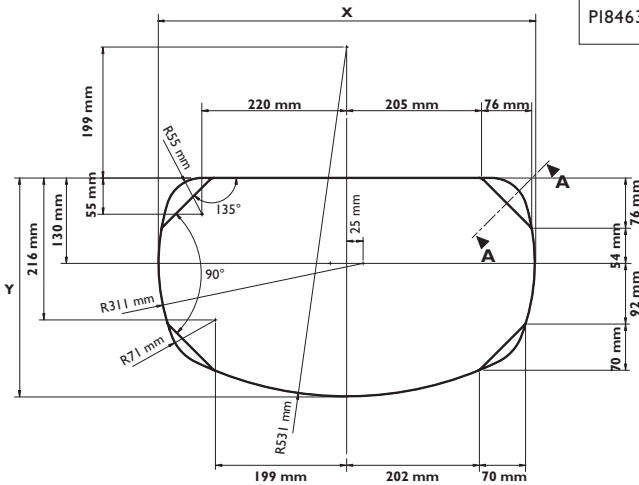

SEZ. A-A

MOD.	X mm	Y mm
PI8621A PI8621S PI8621R	216	296

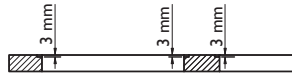

SEZ.A-A

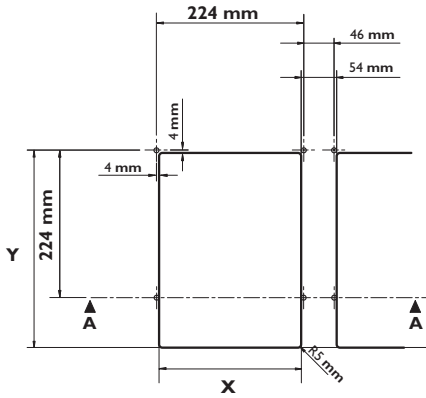

MOD.	X mm	Y mm
PI9003 PI9023	470	473

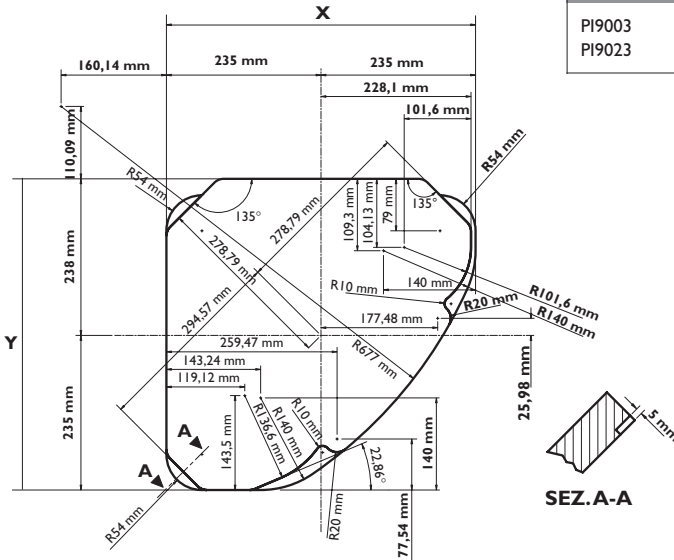

SEZ.A-A

FIG. 3

MOD:

7003	PI7203
7023	PI7223
7103	PI7703
7123	PI7723
MO8302	PI8403
MO8303	PI8423
MO8322	PI8443
MO8323	PI8463
MO8342	PI8802D
MO8362	PI8802S
MO8801D	PI8822D
MO8801S	PI8822S
MO8821D	PI8842D
MO8821S	PI8842S
MO9202D	PI8862D
MO9202S	PI8862S
MO9222D	PI9003
MO9222S	PI9023

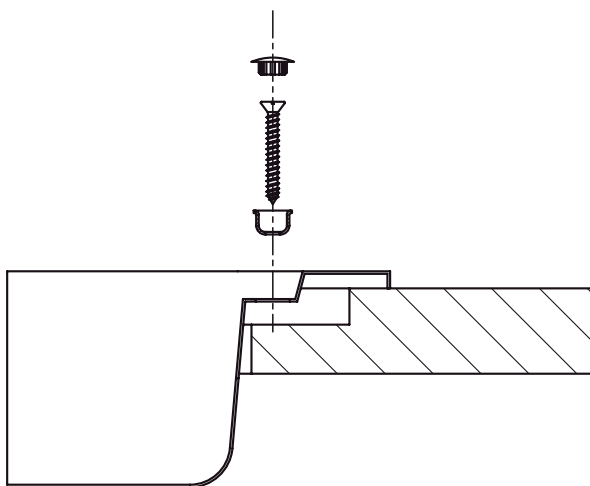

MOD:

- PI8621A
- PI8621R
- PI8621S

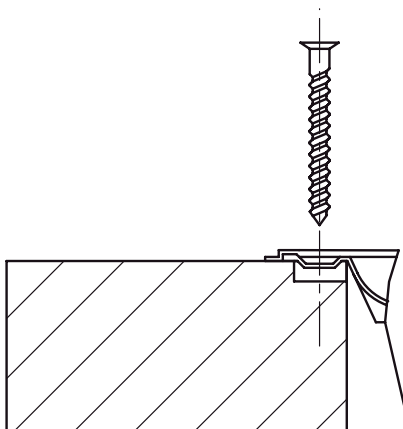

MOD:

- 8103 VD
- 8103 VDM
- 8123 VD
- 8123 VDM
- 8203
- 8203 M
- 8223
- 8223 M

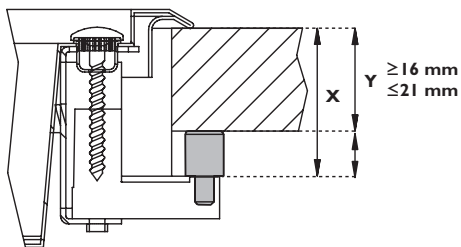
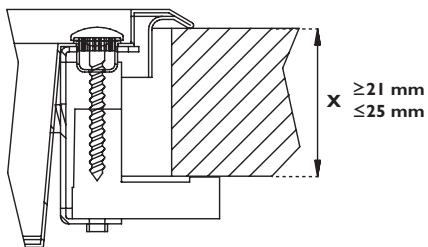

MOD:

- PI8002
- PI8003
- PI8022
- PI8023
- PI8042
- PI8043
- PI8062
- PI8063
- PI8502
- PI8503
- PI8522
- PI8523
- PI8542
- PI8543
- PI8562
- PI8563

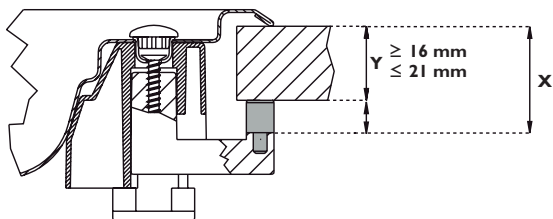
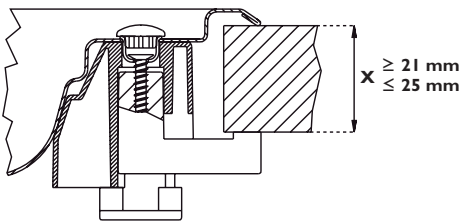

MOD:
MO9122

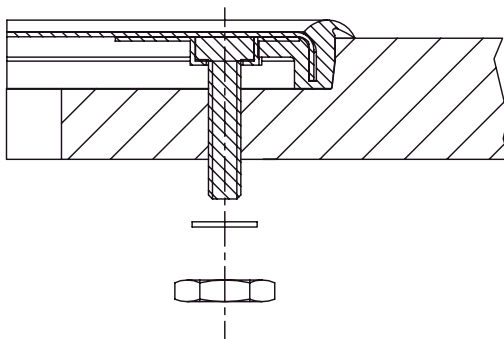

FIG. 4

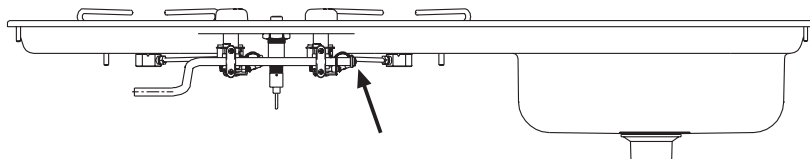

FIG. 5



FIG. 6

