



## BABYFOOT PUMP

GP4618, GP4618B, CS4619B, GP4634, CS4620B

READ CAREFULLY BEFORE  
SERVICING THIS PUMP

**1. To the fitter:  
To Remove &  
Replace Diaphragm**

**1.1** Using standard flat screw driver, loosen the worm drive clip (see fig.1) and remove it from the pump.

**1.2** Peel the diaphragm from body by hand. Exposing spring and spring cap (see fig.1).

**1.3** Replace defective item, always ensure spring cap is correctly in place inside the diaphragm and spring is seated correctly before re assembling.

**1.4** Fit worm drive clip back in place and tighten around diaphragm. (be careful not to overtighten)

**2. To Remove & Replace Nipple  
'O' Ring Seals**

**2.1** Unscrew (anticlockwise) side screws (see fig.1) 2½ turns (there is no need to remove screws fully).

**2.2** Carefully pull end of nipple (see fig.1) or nipple and connecting tube and extract nipple from body.

**2.3** Remove 'O' rings from body of nipple.

**2.4** Fit new 'O' rings into correct 'O' ring grooves (this can easily be done by hand).

**2.5** At this stage, the Babyfoot pump valves may be replaced if necessary.

**2.6** Replace nipple with new 'O' rings back into body, ensuring

key in nipple locates with Keyways in Babyfoot body and push fully home.

**2.7** Screw in side screws (clockwise) do not over-tighten.

**3. To Remove and Replace  
Valves**

**3.1** Having removed diaphragm and nipples (see previous sections), use a pair of long nose pliers to remove both valves by gripping the valve and pulling out of the body.

Note: suction valve pulls out of the spring chamber and outlet valve pulls out of the nipple hole.

**3.2** On the suction side of pump, place the stem of the valve in the center of the input port cartwheel from inside the body by hand.

**3.3** Pull through the valve on the input side using long nose pliers placed up the input port. Pull the valve stem through until it snaps into place.

**3.4** On the delivery side of the pump, gently hold the head of the valve using long nose pliers (see fig. 2) and insert the valve stem in the center of the output port cartwheel from out side of the body.

**3.5** Pull through the valve on the output side using long nose pliers from the inside of the body, gripping the stem and pulling through until the valve snaps into place.

FIG.1

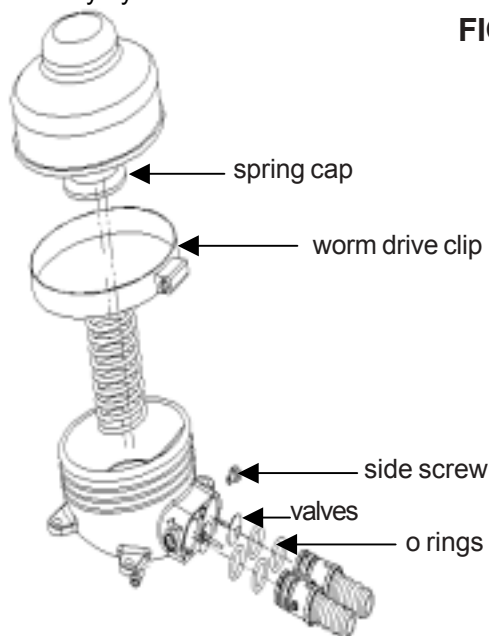

FIG.2

